

International Symposium on ITS Researches

DATE / TIME

Thursday, July 17, 2008 09:20-17:00

<http://www.its.iis.u-tokyo.ac.jp/isir2008>

JUST COME

Free, no need for registration in advance

For expanding ITS toward the future, collaborative operations beyond conventional fields such as information, traffic, mechanical engineering and beyond countries are getting more significance. In conjunction with the coming ITS Asia-Pacific Forum in Singapore, we set up the symposium as a Special Academic Program of the Forum, where we introduce several joint works between and within each and discuss ITS perspectives, through our interfaculty and worldwide collaborative research network.

VENUE

Nanyang Executive Center Auditorium
Nanyang Technological University
<http://www.ntu.edu.sg/nec/>

PROGRAM

The venue opens at 09:00

09:20-09:25	Opening	
	Katsushi Ikeuchi	(The Univ. of Tokyo, Japan)
09:25-11:00	Session 1: Image Processing and Driving Simulator	
Chairs	Cham Tat Jen	(Nanyang Technological Univ., Singapore)
	Shintaro Ono	(The Univ. of Tokyo, Japan)
Presenters	Katsushi Ikeuchi	(The Univ. of Tokyo, Japan)
	Cham Tat Jen	(Nanyang Technological Univ., Singapore)
	Chai Keong Toh	(Nanyang Technological Univ., Singapore)
	Danwei Wang	(Nanyang Technological Univ., Singapore)
11:15-12:30	Session 2: Driver Modeling	
Chairs	Ching-Yao Chan	(California PATH, UC Berkeley, US)
	Daisuke Yamaguchi	(The Univ. of Tokyo, Japan)
Presenters	Takahiro Suzuki	(The Univ. of Tokyo, Japan)
	Ching-Yao Chan	(California PATH, UC Berkeley, US)
	Stephane Espie	(INRETS, France)
13:45-15:00	Session 3: Traffic Management	
Chairs	Shinji Tanaka	(RNUS, AIT, Thailand)
	Edward Chung	(EPFL, Switzerland)
Presenters	Masao Kuwahara	(The Univ. of Tokyo, Japan)
	Seungjae Lee	(Univ. of Seoul, South Korea)
	Edward Chung	(EPFL, Switzerland)
15:15-17:10	Session 4: ITS Perspectives	
Chairs	Katsushi Ikeuchi	(The Univ. of Tokyo, Japan)
	Steven Shladover	(California PATH, UC Berkeley, US)
Presenters	Yoshihiro Suda	(The Univ. of Tokyo, Japan)
	Keqiang Li	(Tsinghua Univ., China)
	Steven Shladover	(California PATH, UC Berkeley, US)
	Hajime Amano	(Toyota Motor Corporation, Japan)
17:10-17:15	Closing	
	Shinji Tanaka	(RNUS, AIT, Thailand)

CHAIRS

General chair: Dr. Katsushi Ikeuchi (The Univ. of Tokyo)
Co-general chair: Dr. Tat Jen (NTU)
Program chair: Dr. Shinji Tanaka (RNUS, AIT)
Publicity chair: Dr. Shintaro Ono (The Univ. of Tokyo)

ORGANIZED/SPONSORED BY

Main organizers: Collaborative Research Center for Advanced Mobility, Institute of Industrial Science, The Univ. of Tokyo; Nanyang Technological Univ (NTU).

Co-organizers: Regional Network office for Urban Safety, Asian Institute of Technology (RNUS, AIT); ITS Japan

Sponsor: ITS Singapore

CONTACT

ITS Center, The University of Tokyo
isir2008-office@its.ccr.u-tokyo.ac.jp

Access guide



Directional map to
NANYANG EXECUTIVE CENTRE
 Nanyang Technological University
 60 Nanyang View
 Singapore 639673

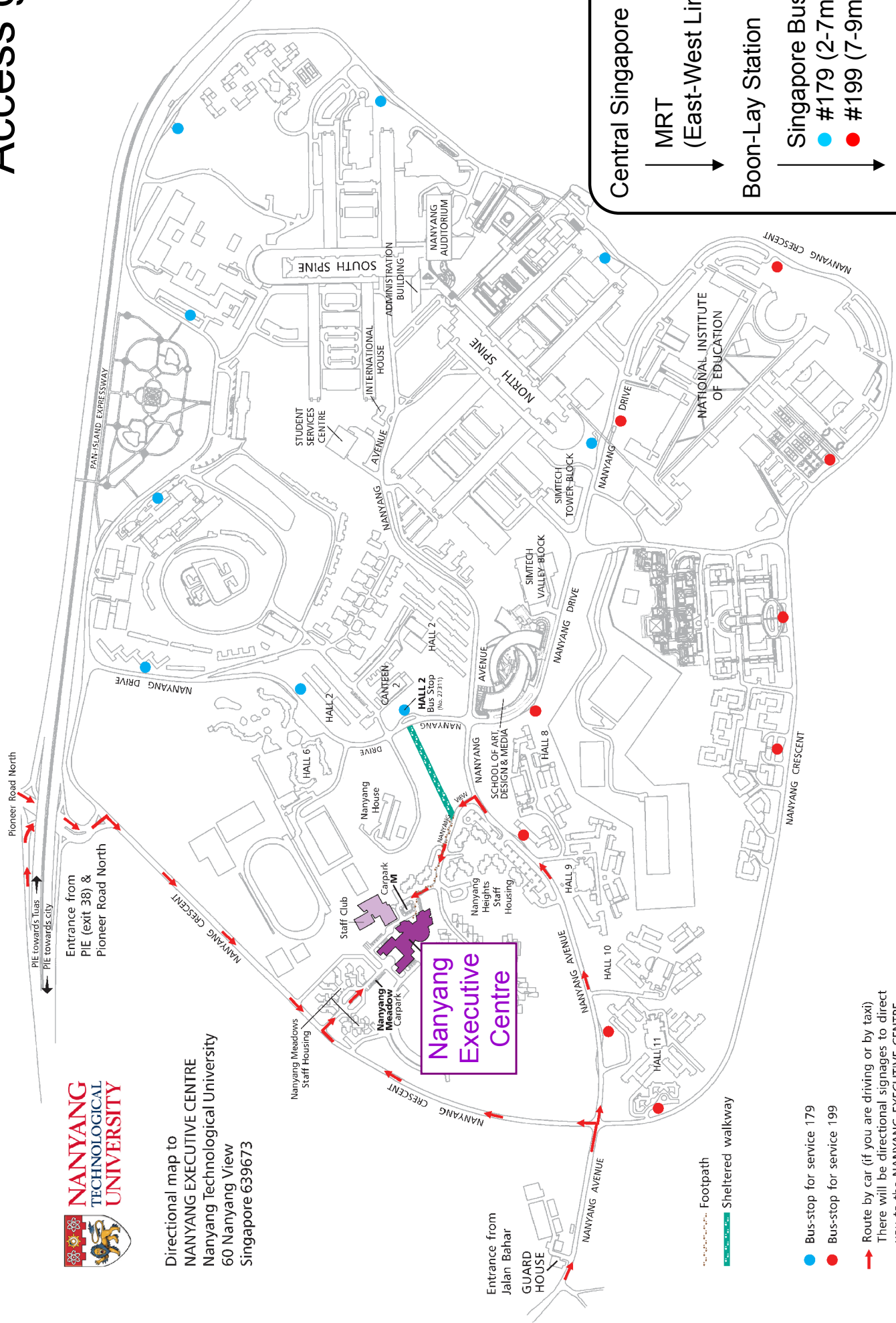

Central Singapore
 MRT (East-West Line)
 Boon-Lay Station
 Singapore Bus Service
 ● #179 (2-7min freq.) or
 ● #199 (7-9min freq.)
 Nanyang Tech. Univ.

- Bus-stop for service 179
- Bus-stop for service 199
- Route by car (if you are driving or by taxi)
 There will be directional signages to direct you to the NANYANG EXECUTIVE CENTRE

Footpath
 Sheltered walkway